

## Contactless, automated measurement of body temperature to secure access areas and workplaces

The HEATDEC temperature measurement system enables automated, contactless measurement of body temperature and thus offers a simple and cost-effective solution for protecting access to workplaces and institutions from potentially infected persons. The complete solution measures the temperature distribution in the facial area with a thermal imaging camera. The technology used was developed with a focus on scientific criteria in order to achieve a high degree of measurement reliability independent of external influences. The intelligent system includes environmental factors and human biorhythm in the evaluation.

### HEATDEC-Basic

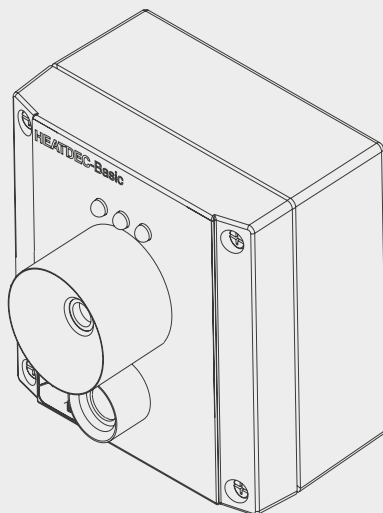

- Automated temperature evaluation as a supporting measurement for controlling the flow of people
- Suitable for implementing the required instructions for action in suspicious cases (SARS-CoV-2 occupational safety standard)
- Protection of personal rights: no face recognition or data storage takes place

# HEATDEC: Temperature measurement by thermal imaging camera

Contactless and automated measurement of body temperature to secure access areas and operational workplaces

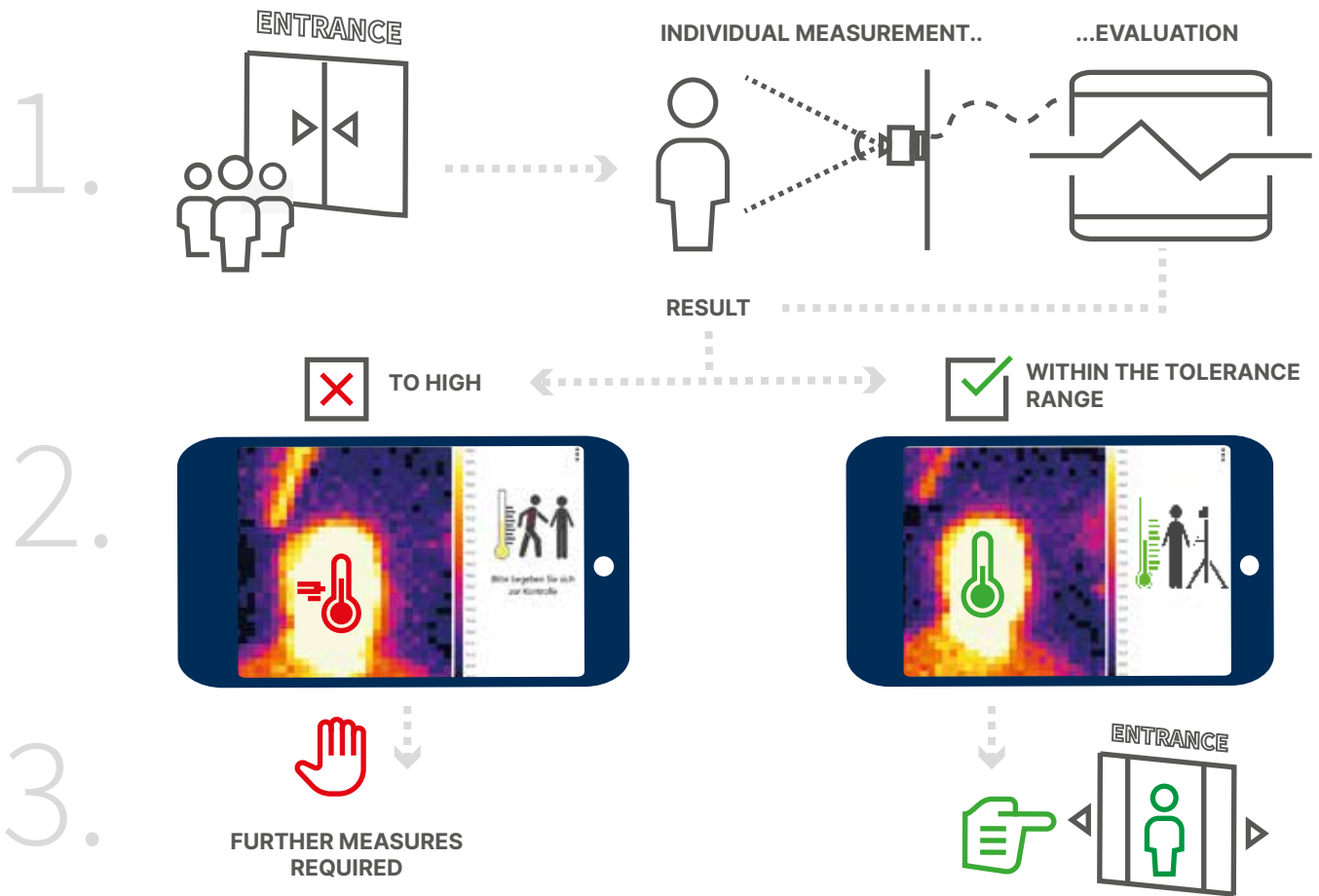

EN 10\_05/2020 Technical changes reserved.

## Product features HEATDEC-Basic

The devices are preconfigured and ready for immediate use.

No face recognition - protection of personal rights according to DSGVO

Live thermal image with visual temperature output

The measurement result is acknowledged with a colour and sound signal.

Ambient and daytime-dependent parameters can be configured.

Each measurement situation is specified: typical scenarios are available as templates.

Intelligent evaluation: The course of measurement is taken into account during evaluation

Approximately 1,000 measurements per hour are possible.

Stand-alone device (230 V connection) | Windows-compatible